

Frequently Asked Questions:

Q: Why aren't signs posted on residential streets to make citizens aware of Town by-laws?

A: Only in certain specific situations, as outlined in the Town's Traffic By-law, are signs required to be posted. There are community by-law signs located at the principle entrances to the Town of Whitby identifying some of the general parking by-laws such as the maximum 3 hour parking limit on any road. These signs are typically located on major roadways and welcome the visitor to the municipality they are entering. For a complete list of Parking By-laws please visit the Town's Website.

Q: How do I dispute a parking ticket?

A: There are two options to dispute a ticket. The first option is booking a First Attendance Review meeting to meet with The Town's Screening Officer. This can be done by filling out an online form, by phone or in person. They will determine if the ticket should be upheld, reduced or cancelled. The second option would be requesting a date for trial.



Safety Starts with You!

Be courteous of the neighbourhood. Don't block driveways, trails or sidewalks. Obey all posted signs and keep the intersections clear.

Active Transportation

Walking or cycling to and from games or event is an excellent way to get exercise, avoid vehicle congestion and reduce pollution.

It is a fun and healthy way for parents and children to spend time together. Be a walking role model!

Plan Ahead

If you can't use an alternative form of transportation, plan ahead. Find out where parking is available for the park you are attending.

For more information on Town of Whitby By-laws, contact Parking Services at:
Phone: 905.430.4300
Email: parking@whitby.ca
Website: www.Whitby.ca/parking

We can help you with questions and/or safety concerns.

WHITBY
ONTARIO • CANADA

Transportation and Parking Services

Welcome to Whitby

Your Guide to Responsible Parking for Summer Activities

Town of Whitby
Public Works Department
Phone: 905.430.4300
Email: parking@whitby.ca
Web: Whitby.ca/parking

Traffic By-law 1862 - 1885:

The most common parking infractions include:

- Parking within 10m of an intersection
- Parking in a signed no parking or no stopping area
- Parking within 3m of a fire hydrant
- Parking on the street for more than 3 hours
- Parking in a fire route
- Parking in an accessible parking space without a valid permit
- Parking a commercial vehicle in a residential zone
- Parking within 1m of a driveway or laneway
- Interfering with road maintenance (Street sweeping, street/catch basin repairs, etc.)

Maintaining walkability and providing a safe active transportation environment for pedestrians and cyclists is very important.

The unimpeded movement of emergency response vehicles is very important; maintaining a safe and direct route for emergency vehicles through our streets is essential to the well-being of our citizens and our visitors.

No Parking Areas



Parking means the stopping of a vehicle for a period of time, whether the vehicle is occupied or not. If you see this sign, you may stop temporarily to quickly drop someone off or pick someone up (if it is safe!), but you may not park your car in order to walk to the park yourself.

Sometimes, these signs are only in effect during certain hours, so check the sign. If there are times listed, that is when the sign applies.



No Stopping Areas

Stopping means that the vehicle, whether occupied or not, is not moving for a reason other than to avoid a collision, to make way for an emergency vehicle or to obey a stop sign or traffic light. Individuals cannot be dropped off within a no stopping zone.

If your vehicle is found in contravention of the Town's Traffic By-law, you may be issued a parking ticket and your vehicle may be towed at your expense. Parking infractions have fines that range from \$15 to \$300.

Intersection Parking

You can not park within 10m of any intersection. Parking a safe distance from the intersection allows for the safe turning movement of vehicles, and safe crossing for pedestrians.

The 10 metres is measured from the curb radius and the no parking restriction includes a t-intersection.

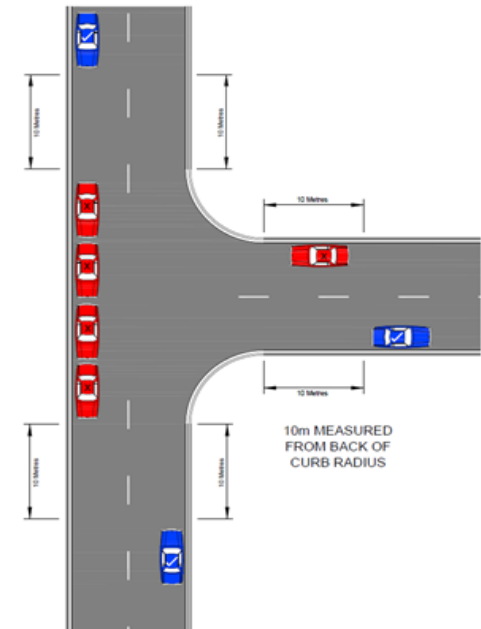

Parking On or Over Sidewalk

Parking on or over a sidewalk, even a small portion of a vehicle, is strictly prohibited.